

WALL SPECIFICATION

TWIN-THERM® WALL CLADDING SYSTEM PROVIDING A 0.20W/m²K U-VALUE.

WALL FIXING ARRANGEMENT

LINER PANEL: LINER PANEL FIXED TO RAILS WITH TSC20G19 SELF-DRILLING FASTENERS AS POSITIONED (TSL36 G19 TO HOT ROLLED RAILS). ALL END LAPS TO BE SEALED WITH T-STRIP 9x3 BUTYL SEALANT AND ALL SIDE LAPS WITH T-FOIL PLUS. WHERE LINER FOAM FILLERS ARE INSTALLED, A FIXING IS REQUIRED IN EVERY PAN TO ENSURE AIR SEAL IS MAINTAINED.

SPACER SYSTEM: THE T-BAR 62W AND T-BLOCK 50 TO BE FIXED INTO THE T-STOOLS WITH TTC81. A MINIMUM OF TWO BLOCKS AND BARS PER 1m ARE REQUIRED. BUILDINGS OVER 10m IN HEIGHT TO EAVES MAY REQUIRE A WIND PRESSURE/SUCTION CALCULATION TO DETERMINE FASTENER FREQUENCY PATTERN.

INSULATION: THE THERMA-QUILT INSULATION IS INSTALLED IN TWO LAYERS, WHERE POSSIBLE CONTINUOUSLY FROM DRIP TO EAVES. WHERE THE WALL HEIGHT EXCEEDS THE ROLL LENGTH A FIRM ABUTMENT IS REQUIRED.

OUTER SHEET: THE OUTER PROFILE SHEET, CORUS COLORCOAT HPS200® ULTRA OR COLORCOAT PRISMA® 0.5mm THICK NOMINAL TO BE FIXED TO THE TOP FLANGE OF THE THERMA-BARS. TOP SHEET FIXED AND SEALED IN ACCORDANCE WITH GUARANTEE REQUIREMENTS (REFER TO TABLE 1 BELOW).

FLASHINGS: ALL FLASHINGS TO BE MANUFACTURED FROM THE SAME BATCH OF MATERIAL USED TO PRODUCE THE OUTER PROFILE TO ENSURE UNIFORM WEATHERING. ALL EXTERNAL FLASHINGS ARE TO BE SEALED AND STITCHED. SIDE AND END LAPS TO BE SEALED USING T-STRIP 9x3 BUTYL SEALANT.

SYSTEM APPRAISAL

LPCB: TESTED IN ACCORDANCE WITH THE LOSS PREVENTION CERTIFICATION BOARD LPS 1181 AND ACHIEVED GRADE EXT-B CERTIFICATION
FIRE: DESIGNATED 'AA' TO BS476:PART 3:2004 & THE LINER PANEL IS CLASS 'O' SURFACE SPREAD OF FLAME TO BS476:PART 7:1997
ACOUSTICS: THE SYSTEMS ACOUSTIC PERFORMANCE HAS BEEN CALCULATED TO ACHIEVE 44dB WEIGHTED NOISE REDUCTION

TABLE 1	CAG SYSTEM GUARANTEE	MAIN FIXING	STITCHER	MAIN FIXING SINU PROFILE	STITCHER SINU PROFILE
HPS200® ULTRA COATED STEEL COMPONENT OPTIONS	UP TO 40 YEARS	CSSC28/16	CSSS23/16	LPHS25A11	LPHS25S11
	UP TO 25 YEARS	CSSC28/16	CSSS23/16	LPHS25A11	LPHS25S11
	UP TO 12 YEARS	CSC32/16	CSS22/16	LPHC25A11	LPHC25S11

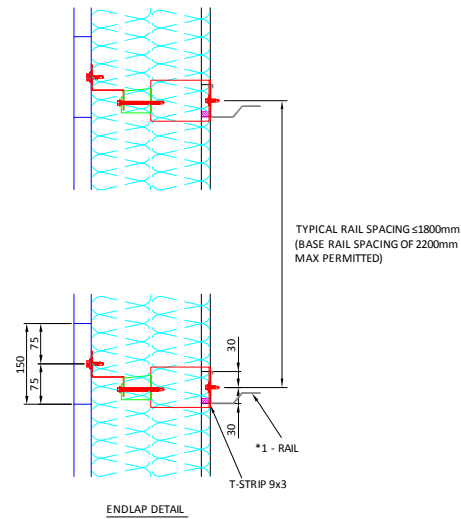

THE INFORMATION CONTAINED IN THIS COMMUNICATION IS CONFIDENTIAL. IT MAY ALSO BE LEGALLY PRIVILEGED. IT IS INTENDED ONLY FOR THE STATED ADDRESSEE(S) AND ACCESS TO IT AND USE BY ANY OTHER PERSON(S) IS UNAUTHORISED. IF YOU ARE NOT AN ADDRESSEE, YOU MUST NOT DISCLOSE, COPY, CIRCULATE OR IN ANY OTHER WAY USE OR RELY UPON THE INFORMATION CONTAINED IN THIS COMMUNICATION. IF YOU HAVE RECEIVED THIS COMMUNICATION IN ERROR, PLEASE INFORM US IMMEDIATELY AND EXPUNGE ALL COPIES FROM YOUR SYSTEMS.

ALL INFORMATION ISSUED BY CA GROUP LIMITED IS SUBJECT TO CONTINUOUS DEVELOPMENT AND THE INFORMATION / DETAILS CONTAINED IN THIS COMMUNICATION ARE CURRENT AT DATE OF ISSUE. IT IS THE ADDRESSEE'S RESPONSIBILITY TO ASCERTAIN FROM CA GROUP LIMITED THAT THE INFORMATION CONTAINED IN THIS COMMUNICATION HAS NOT CHANGED AT THE TIME OF USE BY THE ADDRESSEE.

BSI
ISO 9001
FS10416

DRAWINGS, DETAILS, f -FACTORS AND W-VALUES ARE COVERED BY COPYRIGHT AND ARE OWNED IN FULL BY;
 CA GROUP LIMITED
 COPELAND ROAD, EVENWOOD INDUSTRIAL ESTATE,
 EVENWOOD, CO. DURHAM, DL14 9SF

CA BUILDINGS PRODUCTS' ROOF AND WALL CLADDING SYSTEMS TO BE INSTALLED TO SECONDARY STEELWORK IN ACCORDANCE WITH SCI PUBLICATION '93AG - BEST PRACTICE FOR THE SPECIFICATION AND INSTALLATION OF METAL CLADDING AND SECONDARY STEELWORK'.

CE ALL CA BUILDINGS PRODUCTS' PROFILES ARE CE MARKED IN COMPLIANCE WITH EN 14782: 2006

*1 REFER TO CABP TECHNICAL NOTE TN-33 'THIN GAUGE PURLINS' FOR MINIMUM THICKNESSES OF PURLINS AND CLADDING RAILS.

*2 ADDITIONAL LINER FIXING REQUIRED AT EAVES/HIPS & DRIP (LINER FILLER LOCATIONS)
 *4 ADDITIONAL FASTENERS AT HEAD/EAVES & EXTERNAL SHEET ENLAPS

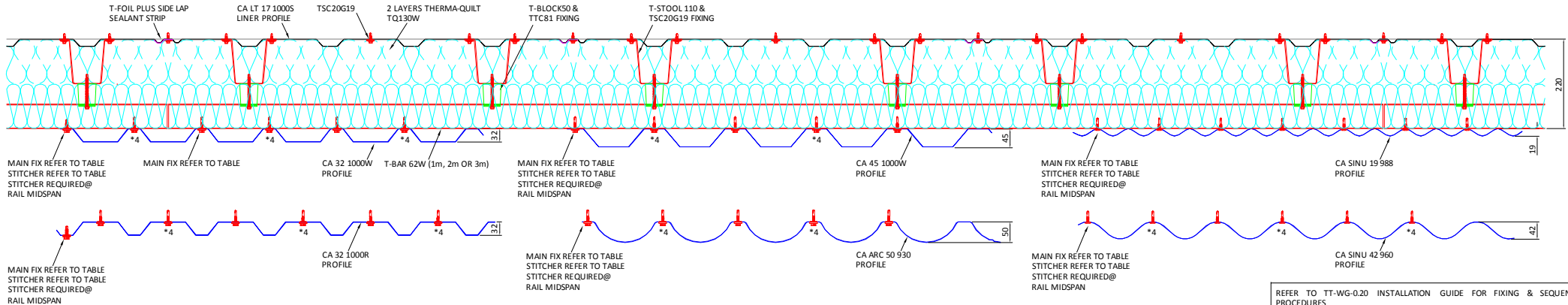

REFER TO TT-WG-020 INSTALLATION GUIDE FOR FIXING & SEQUENCE PROCEDURES

CA Building Products
 Evenwood Industrial Estate
 Copeland Road, Evenwood
 Co. Durham, DL14 9SF

T: 01388 834242 F: 01388 834711
 E: technical@cagroup.ltd.uk
 W: www.cagroup.ltd.uk

TITLE:
**TWIN-THERM® STANDARD WALL BUILD-UP
 & EXTERNAL VERTICAL PROFILE OPTIONS**

CA BUILDING PRODUCTS 0.20W/m²K U-VALUE WALL SPECIFICATION

REVISIONS:

DRAWN M Forrester	CHECKED L Davies
DATE August 2008	SCALE NTS
DRAWING No TT-SDV-04	REV A