

WALL SPECIFICATION

SOLARWALL® PERFORATED TRANSPIRED SOLAR COLLECTOR (PTSC) UTILISING THE TWIN-THERM® FIREWALL INSULATED WALL SYSTEM.

WALL FIXING ARRANGEMENT

TWIN-THERM® FIREWALL INSULATED WALL: VARIOUS U-VALUE OPTIONS ARE AVAILABLE FOR USE WITH THE SOLARWALL® SYSTEM. REFER TO TWIN-THERM® FIREWALL DRAWINGS FOR REFERENCES & BUILD UP DETAILS.

INTERMEDIATE SHEET: CA 32 1000RM ROOF PROFILE, COATED STEEL SHEET 0.5mm THICK NOMINAL TO BE FIXED TO THE TOP FLANGE OF THE T-BARS WITH TSC20G19 SELF-DRILLING CARBON STEEL FASTENERS FIXED THROUGH EVERY OTHER CORRUGATION AT ALL T-BAR POSITIONS (3No PER 1000mm COVER).

CAVITY / CANOPY SPACER SYSTEM: S-STOOL (REFER TO TABLE 2) FIXED TO T-BARS THROUGH THE CA 32 1000RM WITH 2No TSC20G19 PER S-STOOL. TOP HAT 64 FIXED TO S-STOOL (REFER TO TABLE 2) WITH 2No TSC20G16 PER S-STOOL. WHERE TWO TOP HAT SECTIONS JOIN AT AN S-STOOL LOCATION, 4No TSC20G16 (2 PER TOP HAT SECTION) REQUIRED. TOP HAT 64 SPLICED USING TOP HAT 64 SPLICE PLATE AND 8No TSC20G19 FIXINGS WHERE REQUIRED (SEE ISO 01).

SOLARWALL® SHEET: CA 32 1000W SW EXTERNAL WEATHER SKIN 0.7mm THICK NOMINAL PERFORATED SHEET (REFER TO TABLE 1 FOR MATERIAL FINISH & GUARANTEE PERIODS). MAIN FIX (REFER TO TABLE 1) WITH SELF-DRILLING STAINLESS STEEL FASTENERS FIXED THROUGH EVERY OTHER CORRUGATION AT ALL SUPPORTS (SEE NOTE *3). SIDE LAPS STITCHED AT MID SPAN BETWEEN RAILS WITH SELF-DRILLING STAINLESS STEEL STITCHERS (REFER TO TABLE 1). VARIOUS EXTERNAL PROFILE & COLOUR OPTIONS ARE AVAILABLE, PLEASE CONTACT CABP TECHNICAL DEPARTMENT FOR FURTHER INFORMATION.

FLASHINGS: ALL FLASHINGS TO BE MANUFACTURED FROM THE SAME BATCH OF MATERIAL USED TO PRODUCE THE EXTERNAL SHEET TO ENSURE UNIFORM WEATHERING. ALL EXTERNAL FLASHING SIDE AND END LAPS TO BE STITCHED & SEALED USING T-STRIP BUTYL SEALANT.

CAVITY & CANOPY DEPTHS

NOTE: THE CAVITY IS REQUIRED TO ALLOW THE HEATED AIR TO FLOW VERTICALLY & UNRESTRICTED TO THE CANOPY AREA. ONCE AT THE CANOPY, THE AIR FLOW CHANGES DIRECTION TO A HORIZONTAL PATH AND PROCEEDS UNRESTRICTED TO THE NEAREST AVAILABLE FAN UNIT.

SYSTEM APPRAISAL

RATING: 240 MINUTES INTEGRITY AND 15 MINUTES INSULATION TO BS476: PART 22: 1987
LPCB: TESTED IN ACCORDANCE WITH THE LOSS PREVENTION CERTIFICATION BOARD LPS 1181, ACHIEVING GRADE EXT-A15 CERTIFICATION.
FIRE: DESIGNATED 'AA' TO BS476: PART 3: 2004 & THE LINER PANEL IS CLASS 'O' SURFACE SPREAD OF FLAME TO BS476:PART 7: 1997.

TABLE 1

EXTERNAL WEATHER SKIN MATERIAL (FIGURES STATED BASED ON WALL CLADDING)	CONFIDEX® GUARANTEE	CAG SYSTEM GUARANTEE	SIDE & END LAP SEALANTS	MAIN FIXING	STITCHER
COLORCOAT HPS200® ULTRA COATED STEEL	UP TO 40 YEARS	UP TO 40 YEARS	N/A	CSSC28/16	CSSS23/16
	UP TO 25 YEARS	UP TO 25 YEARS	N/A	CSSC28/16	CSSS23/16
COLORCOAT PRISMA® COATED STEEL	UP TO 25 YEARS	UP TO 25 YEARS	N/A	CSSC28/16	CSSS23/16

TABLE 2

SOLARWALL® OPTION	CAVITY			CANOPY		
	DEPTH 'B' (mm)	S-STOOL DEPTH (mm)	TOP HAT DEPTH (mm)	HEIGHT (mm)	DEPTH 'C' (mm)	AREA (m²)
1	110	120	64	3600	152	0.547
2	140	150	64	3600	182	0.655
3	190	200	64	3600	232	0.835

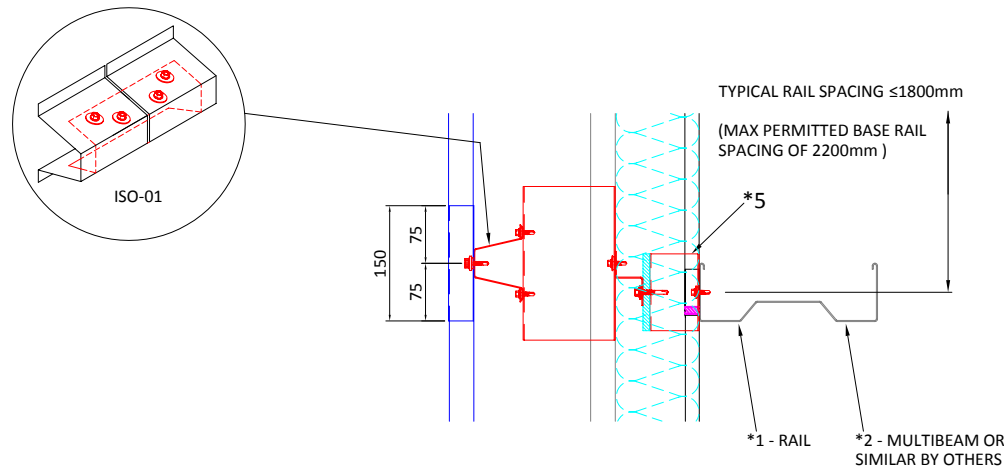

THE INFORMATION CONTAINED IN THIS COMMUNICATION IS CONFIDENTIAL. IT MAY ALSO BE LEGALLY PRIVILEGED. IT IS INTENDED ONLY FOR THE STATED ADDRESSEE(S) AND ACCESS TO IT AND USE BY ANY OTHER PERSON(S) IS UNAUTHORISED. IF YOU ARE NOT AN ADDRESSEE, YOU MUST NOT DISCLOSE, COPY, CIRCULATE OR IN ANY OTHER WAY USE OR RELY UPON THE INFORMATION CONTAINED IN THIS COMMUNICATION. IF YOU HAVE RECEIVED THIS COMMUNICATION IN ERROR; PLEASE INFORM US IMMEDIATELY AND EXPUNGE ALL COPIES FROM YOUR SYSTEMS.

ALL INFORMATION ISSUED BY CA GROUP LIMITED IS SUBJECT TO CONTINUOUS DEVELOPMENT AND THE INFORMATION / DETAILS CONTAINED IN THIS COMMUNICATION ARE CURRENT AT DATE OF ISSUE. IT IS THE ADDRESSEE'S RESPONSIBILITY TO ASCERTAIN FROM CA GROUP LIMITED THAT THE INFORMATION CONTAINED IN THIS COMMUNICATION HAS NOT CHANGED AT THE TIME OF USE BY THE ADDRESSEE.

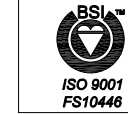

DRAWINGS, DETAILS, f -FACTORS AND ψ-VALUES ARE COVERED BY COPYRIGHT AND ARE OWNED IN FULL BY; CA GROUP LIMITED
 COPELAND ROAD, EVENWOOD INDUSTRIAL ESTATE, EVENWOOD, CO. DURHAM. DL14 9SF

CA BUILDINGS PRODUCTS' ROOF AND WALL CLADDING SYSTEMS TO BE INSTALLED TO SECONDARY STEELWORK IN ACCORDANCE WITH SCI PUBLICATION 'P346 - BEST PRACTICE FOR THE SPECIFICATION AND INSTALLATION OF METAL CLADDING AND SECONDARY STEELWORK'.

ALL CA BUILDINGS PRODUCTS' PROFILES ARE CE MARKED IN COMPLIANCE WITH EN 14782: 2006

*1 REFER TO CABP TECHNICAL NOTE TN-33 'THIN GAUGE PURLINS' FOR MINIMUM THICKNESSES OF PURLINS AND CLADDING RAILS.

*2 PLEASE REFER TO CABP TECHNICAL NOTE TN-03 'SYSTEM U-VALUES & WEIGHTS' FOR SOLARWALL® SYSTEM WEIGHTS UTILISING THE TWIN-THERM® INSULATED WALL CLADDING SYSTEM. IT SHOULD BE VERIFIED PRIOR TO INSTALLATION THAT THE SECONDARY / MAIN STEELWORK IS CAPABLE OF SUPPORTING THE TOTAL LOAD IMPOSED BY THE COMPLETE TWIN-THERM® SOLARWALL® SYSTEM.

*3 ADDITIONAL FASTENERS REQUIRED AT DRIP, EAVES & EXTERNAL SHEET ENDLAPS

*4 STITCHER REQUIRED AT SIDE LAP, STITCHED AT MID SPAN BETWEEN RAILS.

*5 FOR TWIN-THERM® FIREWALL SOLARWALL® INSTALLATIONS, 3No TOP HATS ARE REQUIRED AT DRIP, EAVES AND INTERMEDIATE SHEET END LAPS.

IT IS RECOMMENDED THAT FOR SOLARWALL® INSTALLATIONS, A WIND PRESSURE / SUCTION CALCULATION IS UNDERTAKEN TO DETERMINE S-STOOL FREQUENCY PATTERN.

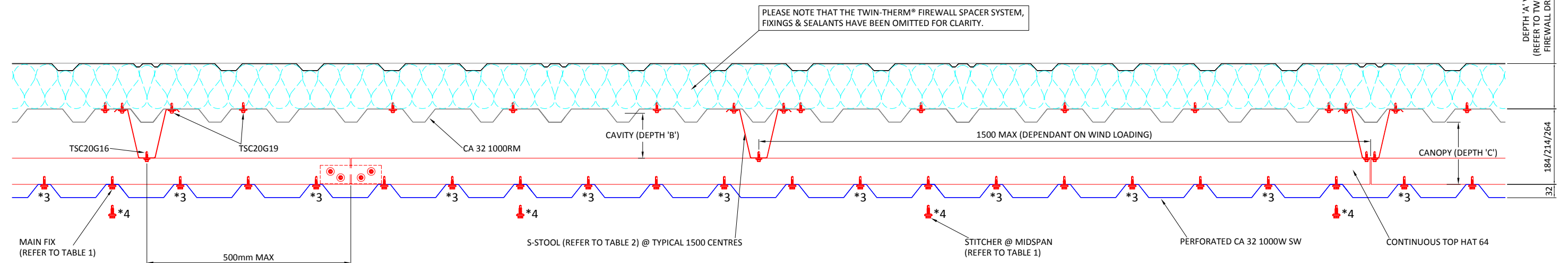

SECTION THROUGH

REFER TO TWIN-THERM® SOLARWALL® INSTALLATION GUIDE FOR FIXING & SEQUENCE PROCEDURES.



CA Building Products
 Evenwood Industrial Estate
 Copeland Road, Evenwood
 Co. Durham. DL14 9SF
 T: 01388 834242 F: 01388 834711
 E: solarwall@cagroup.ltd.uk
 W: www.cagroup.ltd.uk

TITLE:
TWIN-THERM® FIREWALL SOLARWALL® PERFORATED TRANSPIRED SOLAR COLLECTOR
OPTION 1, 2 & 3
VERTICALLY LAID EXTERNAL SHEET

CA BUILDING PRODUCTS 0.35 - 0.20W/m²K U-VALUE WALL SPECIFICATION

REVISIONS:

DRAWN D YOUNG	CHECKED A BREWSTER
DATE MARCH 2009	SCALE NTS
DRAWING No SW-SVfV-03	REV A