

**ACCESS HATCH DETAIL (FLASHING BACK TO RIDGE) SECTION 1**

LINEAR THERMAL PERFORMANCE IN ACCORDANCE WITH BUILDING REGULATIONS APPROVED DOCUMENT L2:2006

ACCESS HATCH U-VALUE = 2.38W/m²K

WHEN THE PENETRATION IS LESS THAN 300mm SQUARE (OR DIAMETER) TRIMMING STEELWORK IS NOT REQUIRED WHEN GREATER THAN 300mm SQUARE TRIMMING STEELWORK IS REQUIRED

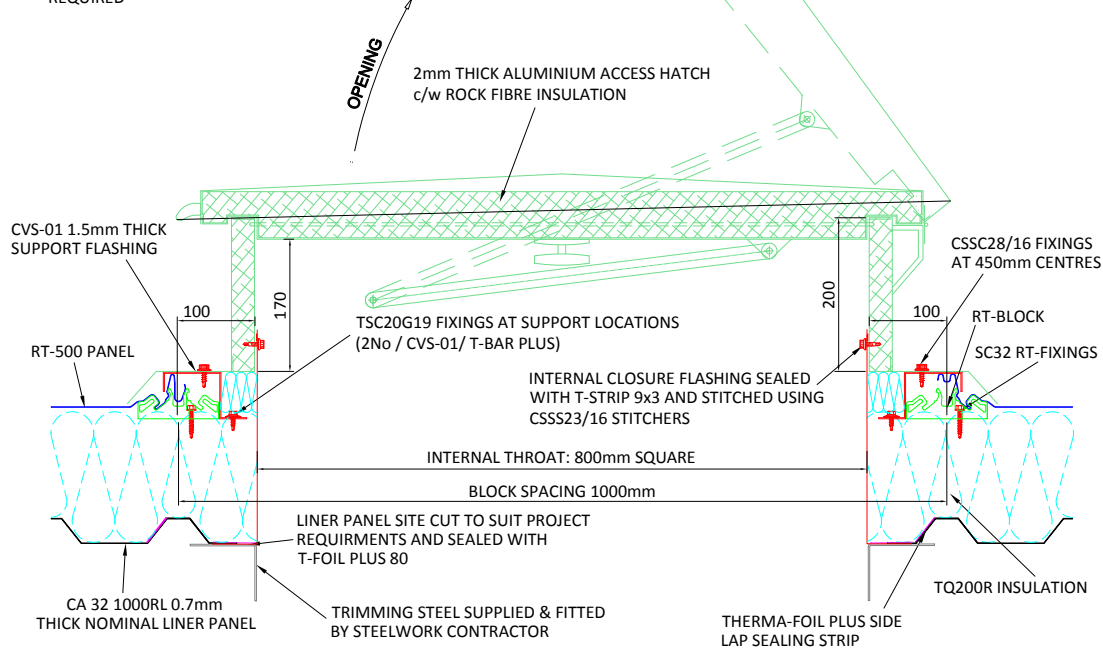

**ACCESS HATCH DETAIL (WELDED/ GRP SEALED) SECTION 1**

LINEAR THERMAL PERFORMANCE IN ACCORDANCE WITH BUILDING REGULATIONS APPROVED DOCUMENT L2:2006

ACCESS HATCH U-VALUE = 2.38W/m²K

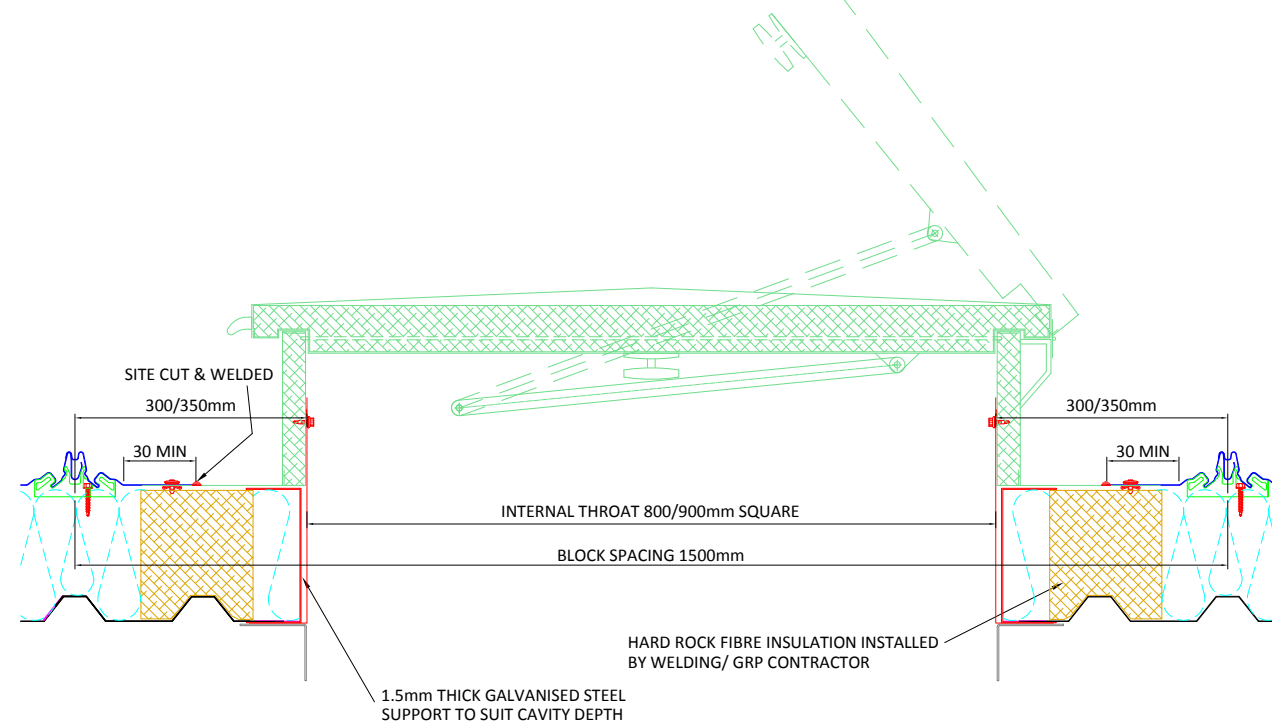

**ACCESS HATCH DETAIL (FLASHING BACK TO RIDGE) SECTION 2**

LINEAR THERMAL PERFORMANCE IN ACCORDANCE WITH BUILDING REGULATIONS APPROVED DOCUMENT L2:2006

ACCESS HATCH U-VALUE = 2.38W/m²K

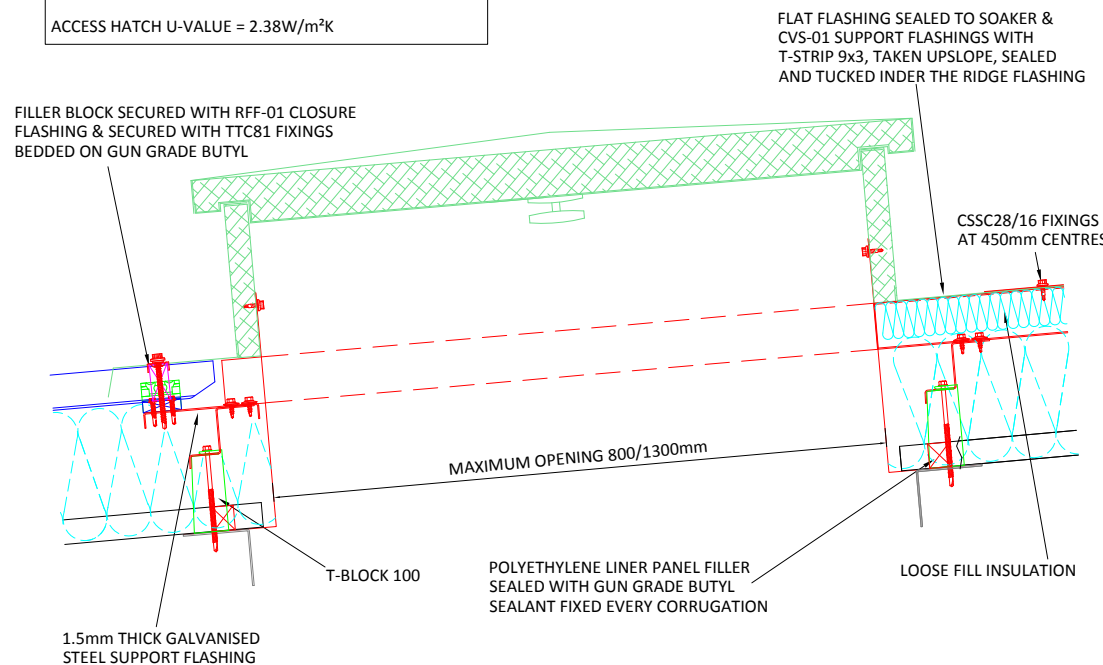

**ACCESS HATCH DETAIL (WELDED/ GRP SEALED) SECTION 2**

LINEAR THERMAL PERFORMANCE IN ACCORDANCE WITH BUILDING REGULATIONS APPROVED DOCUMENT L2:2006

ACCESS HATCH U-VALUE = 2.38W/m²K

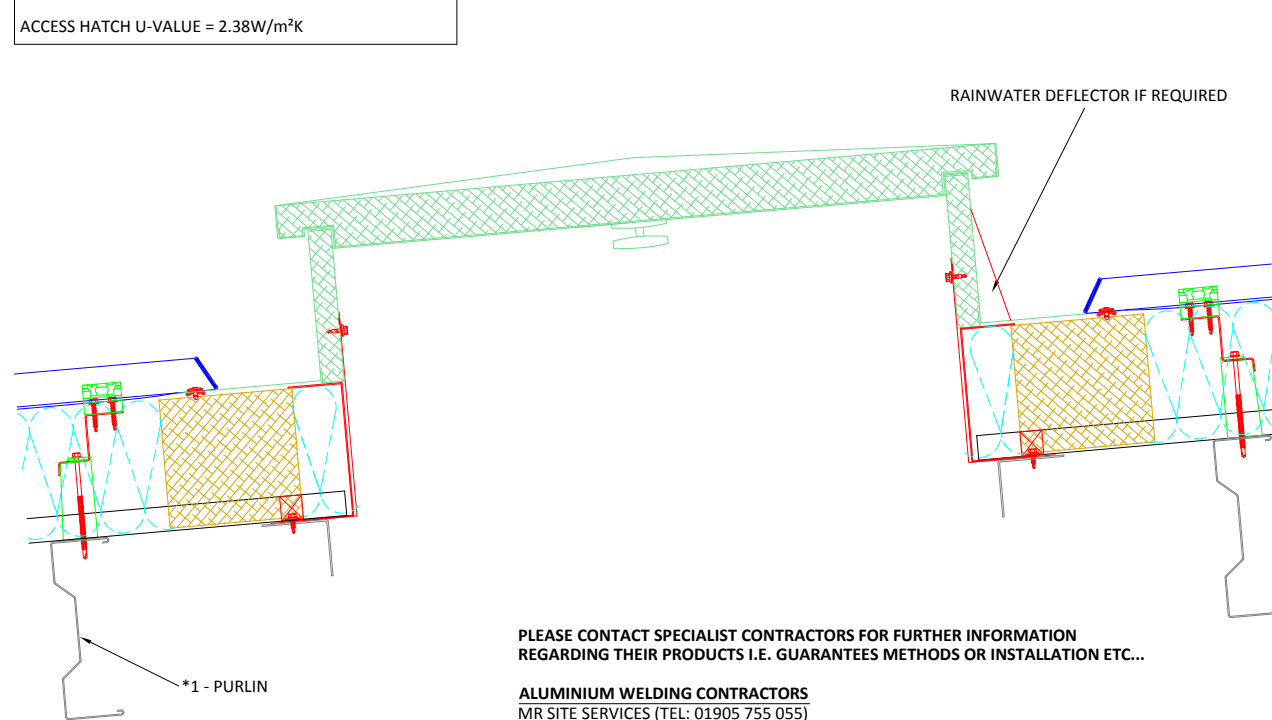

PLEASE CONTACT SPECIALIST CONTRACTORS FOR FURTHER INFORMATION REGARDING THEIR PRODUCTS I.E. GUARANTEES METHODS OR INSTALLATION ETC...

**ALUMINIUM WELDING CONTRACTORS**  
MR SITE SERVICES (TEL: 01905 755 055)

**HPS200® ULTRA COATED STEEL SEALING CONTRACTORS**  
MILLENNIUM GRP SOLUTIONS (TEL: 01902 635 555)  
MR SITE SERVICES (TEL: 01905 755 055)

THE INFORMATION CONTAINED IN THIS COMMUNICATION IS CONFIDENTIAL. IT MAY ALSO BE LEGALLY PRIVILEGED. IT IS INTENDED ONLY FOR THE STATED ADDRESSEE(S) AND ACCESS TO IT AND USE BY ANY OTHER PERSON(S) IS UNAUTHORISED. IF YOU ARE NOT AN ADDRESSEE, YOU MUST NOT DISCLOSE, COPY, CIRCULATE OR IN ANY OTHER WAY USE OR RELY UPON THE INFORMATION CONTAINED IN THIS COMMUNICATION. IF YOU HAVE RECEIVED THIS COMMUNICATION IN ERROR; PLEASE INFORM US IMMEDIATELY AND EXPUNGE ALL COPIES FROM YOUR SYSTEMS.

ALL INFORMATION ISSUED BY CA GROUP LIMITED IS SUBJECT TO CONTINUOUS DEVELOPMENT AND THE INFORMATION / DETAILS CONTAINED IN THIS COMMUNICATION ARE CURRENT AT DATE OF ISSUE. IT IS THE ADDRESSEE'S RESPONSIBILITY TO ASCERTAIN FROM CA GROUP LIMITED THAT THE INFORMATION CONTAINED IN THIS COMMUNICATION HAS NOT CHANGED AT THE TIME OF USE BY THE ADDRESSEE.



DRAWINGS, DETAILS, f -FACTORS AND ψ-VALUES ARE COVERED BY COPYRIGHT AND ARE OWNED IN FULL BY; CA GROUP LIMITED  
COPELAND ROAD, EVENWOOD INDUSTRIAL ESTATE, EVENWOOD, CO. DURHAM. DL14 9SF

CA BUILDINGS PRODUCTS' ROOF AND WALL CLADDING SYSTEMS TO BE INSTALLED TO SECONDARY STEELWORK IN ACCORDANCE WITH SCI PUBLICATION 'P346 - BEST PRACTICE FOR THE SPECIFICATION AND INSTALLATION OF METAL CLADDING AND SECONDARY STEELWORK'.

ALL CA BUILDINGS PRODUCTS' PROFILES ARE CE MARKED IN COMPLIANCE WITH EN 14782: 2006

\*1 REFER TO CABP TECHNICAL NOTE TN-33 'THIN GAUGE PURLINS' FOR MINIMUM THICKNESSES OF PURLINS AND CLADDING RAILS.

**RIDGE FIXING METHOD**

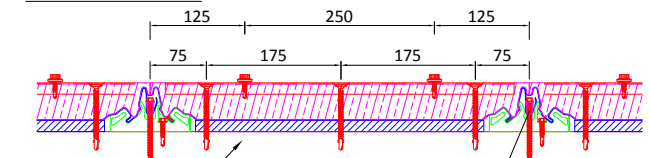

3 NUMBER T30 5.5x80 FIXINGS REQUIRED PER PANEL TO SECURE THE CLOSURE FLASHING AND FILLER BLOCK AS SHOWN - CSSC28/16 FIXINGS @ 250mm CENTRES REQUIRED TO SECURE RIDGE FLASHING.

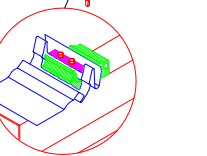

**PENETRATION INFORMATION**

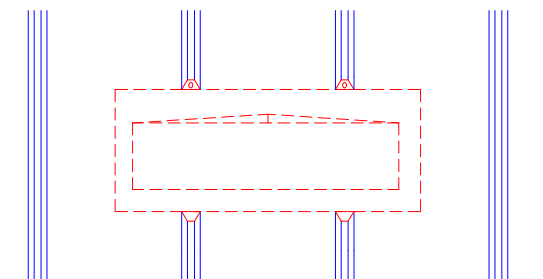

1. MINIMUM DISTANCE FROM CENTRE OF BLOCK TO END OF PANEL IS 150mm
2. DRAINAGE CHANNELS MUST BE OPENED TO BRING IN LINE WITH PAN OF RT-500
3. COVER PLATE FOR PROFILE SHOULD BE SEALED/ WELDED IN SUCH A WAY AS NOT TO PREVENT DRAINAGE FROM THE MIDDLE CHANNEL DOWNSLOPE
4. RAINWATER DEFLECTORS MAY BE REQUIRED DEPENDING ON PENETRATION SIZE TO AID WATER RUN OFF
5. DRAINAGE CHANNELS SHOULD NOT BE BLOCKED BY SEALING MATERIALS THAT WOULD CAUSE CA BUILDING PRODUCTS GUARANTEES TO BE VOIDED

THE RIVER-THERM® ROOF SUPPORT SYSTEM HAS BEEN REMOVED FROM THESE DETAILS FOR CLARITY OF CONSTRUCTION, PLEASE REFER TO SPECIFIC SPECIFICATION DRAWING DEPENDING ON PROJECT U-VALUE REQUIREMENTS FOR MORE INFORMATION.

THE THERMAL FIGURES QUOTED ARE INDICATIVE ONLY, ALL PROJECT SPECIFIC PENETRATIONS MUST BE CALCULATED BASED ON SIZE AND SPECIFICATION. PLEASE CONTACT CA BUILDING PRODUCTS EITHER BY PHONE, FAX OR EMAIL.



CA Building Products  
Evenwood Industrial Estate  
Copeland Road, Evenwood  
Co. Durham. DL14 9SF

T: 01388 834242 F: 01388 834711  
E: technical@cagroup.ltd.uk  
W: www.cagroup.ltd.uk

TITLE:  
**RIVER-THERM® STANDARD ROOF DETAILS**  
**ACCESS HATCH DETAILS**

CA BUILDING PRODUCTS 0.25W/m²K U-VALUE ROOF SPECIFICATION

REVISIONS:

DRAWN

S Brown

DATE

August 2008

DRAWING No

RT-DDR-08

CHECKED

L Davies

SCALE

NTS

REV A